

1-800-639-2199

Fax (603) 224-2927

Trench Drains\3ft and 6ft Residential Trench Drain_(v)

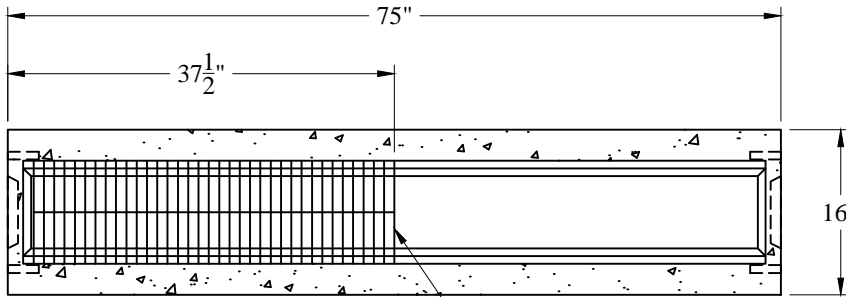
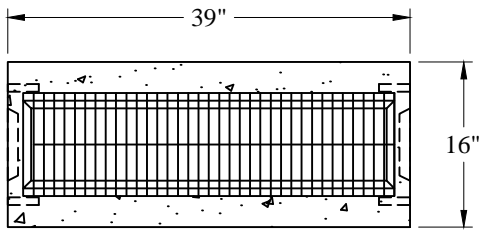

9 1/2" x 3" Bar Grating
Painted Finish (Black)

See Note 5

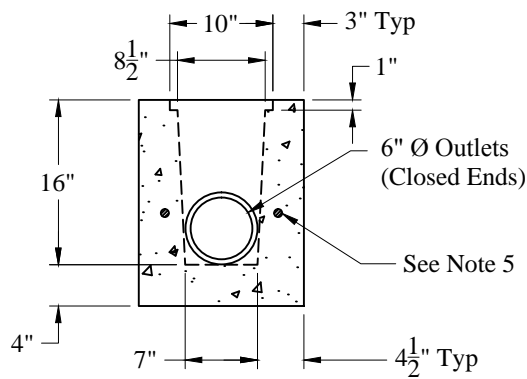
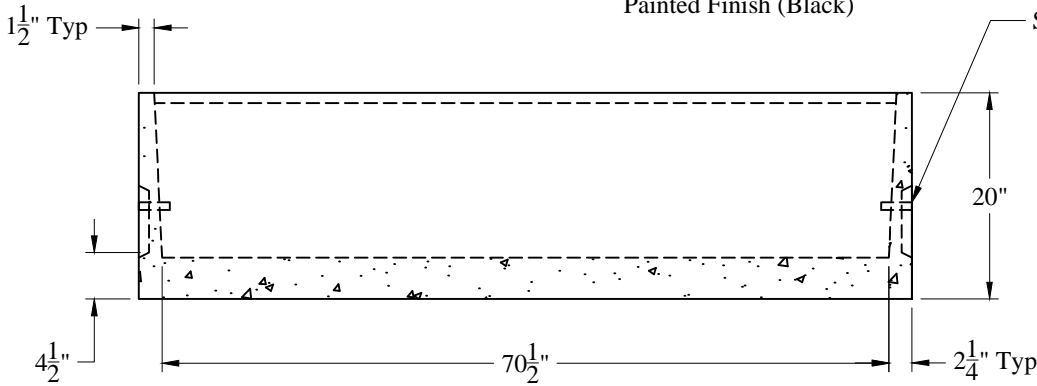

Style	Length	P/N:
3' O/O	36"	TD-3O
3' O/C	37.5"	TD-3OC
3' C/C	39"	TD-3C
6' O/O	72"	TD-6O
6' O/C	73.5"	TD-6OC
6' C/C	75"	TD-6C

Est Weight: 215 Lbs/LF

General Notes

1. Reinforcing Steel ASTM A-615 Grade 60
2. Concrete: $f_c = 4,000$ psi @ 28 Days Minimum
3. Design Loading: AASHTO-HS20-44
4. Available In 3' and 6' Sections
5. Connect With $\frac{3}{4}$ " x $5\frac{1}{2}$ " Round Steel Bar Pins
6. Available in:
 - Both ends Closed (C/C)
 - Both Ends Open (O/O)
 - One End Open/Other End Closed (O/C)

Phoenix Precast Products

Phoenix Precast Products

Phoenix
Precast
Products

Trench Drain